

# Low Pressure Steel Pipe Fittings

Equal Dia. Pipe Threads

## Sockets

RoHS



Type	M Material	S Surface Treatment
SGPPS	FCMB270	Hot Zinc Plating
SUTPS	304 Stainless Steel	-
SUTPSS	316 Stainless Steel	-

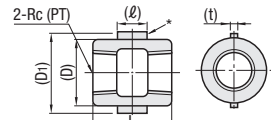

\*Only SGPPS has claws on the circumference.

Part Number	Type	No.	Rc (PT)	SGPPS			SUTPS, SUTPSS			SGPPS		SUTPS		SUTPSS	
				(D)	L (D)	(t)	(D)	L	Unit Price	Volume Discount Rate	Unit Price	Volume Discount Rate	Unit Price	Volume Discount Rate	
SGPPS SUTPS SUTPSS	6A	1/8	15	23	19	13	4	15	23	-	-	-	-		
	8A	1/4	19	26	22	17	4	19	29	-	-	-	-		
	10A	3/8	24	31	27	18	5	22	30	-	-	-	-		
	15A	1/2	28	35	31	20	6	27	38	-	-	-	-		
	20A	3/4	34	41	37	24	6	33	40	-	-	-	-		
	25A	1	43	45	46	25	8	40	45	-	-	-	-		
	32A	1 1/4	51	50	54	28	8	49	51	-	-	-	-		
	40A	1 1/2	57	55	61	32	9	55.5	54	-	-	-	-		
	50A	2	70	60	75	34	9	68	64	-	-	-	-		

## Parallel Female Thread (PS) Socket

RoHS



Type	M Material	S Surface Treatment
SGPRP	Carbon Steel Pipes	Hot Zinc Plating
SUTRP	304 Stainless Steel	-

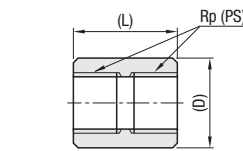

Part Number	Type	No.	Rp (PS)	SGPRP		SUTRP		SGPRP		SUTRP	
				(D)	(L)	(D)	(L)	Unit Price	Volume Discount Rate	Unit Price	Volume Discount Rate
SGPRP SUTRP	6A	1/8	15	19	13.8	20	-	-	-	-	
	8A	1/4	19	27	17	25	-	-	-	-	
	10A	3/8	23	28	21	26	-	-	-	-	
	15A	1/2	28	37	25	33	-	-	-	-	
	20A	3/4	34.5	39	31	36	-	-	-	-	
	25A	1	41.5	46	38	43	-	-	-	-	
	32A	1 1/4	51	51	47	48	-	-	-	-	

## Double Long Socket

RoHS



Type	M Material	S Surface Treatment
SUTPSR	304 Stainless Steel	-

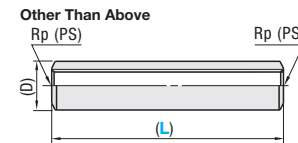
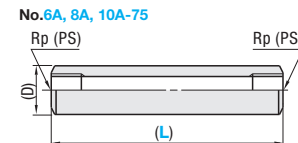

Part Number	Type	No.	(L)	Rp (PS)	(D)	Unit Price		Volume Discount Rate	
						1-9 pc(s)	10-29 pcs	1-9 pc(s)	10-29 pcs
SUTPSR	6A	1/8	14.5	-	-	-	-	-	-
	8A	1/4	19	-	-	-	-	-	-
	10A	3/8	22	-	-	-	-	-	-
	15A	1/2	26.5	-	-	-	-	-	-
	20A	3/4	33	-	-	-	-	-	-

## Elbows

RoHS



Type	M Material	S Surface Treatment
SGPPE	FCMB270	Hot Zinc Plating
SUTPE	CF-8 Stainless Steel Cast	-
SUTPES	CF-8M Stainless Steel Cast	-

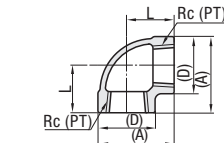

Part Number	Type	No.	Rc (PT)	SGPPE		SUTPE, SUTPES		SGPPE		SUTPE		SUTPES	
				(D)	L (A)	(D)	L (A)	Unit Price	Volume Discount Rate	Unit Price	Volume Discount Rate	Unit Price	Volume Discount Rate
SGPPE SUTPE SUTPES	6A	1/8	15	17	24.5	22	19	30	-	-	-	-	
	8A	1/4	19	19	28.5	22	19	30	-	-	-	-	
	10A	3/8	24	23	35	26	23	36	-	-	-	-	
	15A	1/2	28	27	41	30	27	42	-	-	-	-	
	20A	3/4	34	34	49	36	32	50	-	-	-	-	
	25A	1	43	38	59.5	44	38	60	-	-	-	-	
	32A	1 1/4	51	46	71.5	53	46	74	-	-	-	-	
	40A	1 1/2	57	48	76.5	60	48	78	-	-	-	-	
	50A	2	70	57	92	73	57	95	-	-	-	-	

## 45° Elbow

RoHS



Type	M Material	S Surface Treatment
SGPHE	FCMB270	Hot Zinc Plating
SUTHE	CF-8 Stainless Steel Cast	-

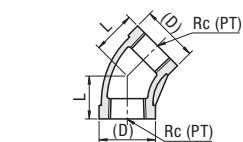

Part Number	Type	No.	Rc (PT)	SGPHE		SUTHE		SGPHE		SUTHE	
				(D)	L	(D)	L	Unit Price	Volume Discount Rate	Unit Price	Volume Discount Rate
SGPHE SUTHE	6A	1/8	18	16	17	16	-	-	-	-	
	8A	1/4	22	17	21	17	-	-	-	-	
	10A	3/8	26	19	25	19	-	-	-	-	
	15A	1/2	30	21	28	21	-	-	-	-	
	20A	3/4	36	25	35	25	-	-	-	-	

## Male / Female Threads, Elbow

RoHS



Type	M Material	S Surface Treatment
SGPPEL	FCMB270	Hot Zinc Plating
SUTPEL	CF-8 Stainless Steel Cast	-

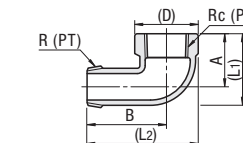

Part Number	Type	No.	R, Rc (PT)	SGPPEL				SUTPEL				SGPPEL		SUTPEL	
				(D)	(L)	(L)	A	B	(D)	(L)	(L)	A	B	Unit Price	Volume Discount Rate
SGPPEL SUTPEL	6A	1/8	19	23	36	17	26	14.5	22	33	17	26	-	-	
	8A	1/4	22	26	42	19	30	19	24.3	38.5	19	30	-	-	
	10A	3/8	27	31	48	23	35	23	29.8	46.5	23	35	-	-	
	15A	1/2	31	38	56	27	40	27	35.8	53.5	27	40	-	-	
	20A	3/4	36	45	66	32	47	33	43.3	63.5	32	47	-	-	
	25A	1	45	55	76.5	38	54	41	52.5	74.5	38	54	-	-	
	32A	1 1/4	55	67	88.5	46	62	50	64	87	46	62	-	-	
	40A	1 1/2	62	72	99	48	68	56	68.5	96	48	68	-	-	
	50A	2	75	87	116.5	57	79	69	83	113.5	57	79	-	-	

## Tee

RoHS



Type	M Material	S Surface Treatment
SGPPT	FCMB270	Hot Zinc Plating
SUTPT	CF-8 Stainless Steel Cast	-

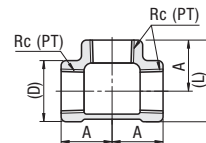

Part Number	Type	No.	Rc (PT)	SGPPT			SUTPT			SGPPT		SUTPT	
				(D)	(L)	A	(D)	(L)	A	Unit Price	Volume Discount Rate	Unit Price	Volume Discount Rate
SGPPT SUTPT	6A	1/8	16	25.5	17	22	30	19	-	-	-	-	
	8A	1/4	20	29	19	22	30	19	-	-	-	-	
	10A	3/8	24	35.5	23	26	36	23	-	-	-	-	
	15A	1/2	28	42	27	30	42	27	-	-	-	-	
	20A	3/4	34	50	32	36	50	32	-	-	-	-	
	25A	1	43	59.5	38	44	60	38	-	-	-	-	
	32A	1 1/4	51	71.5	46	53	73	46	-	-	-	-	
	40A	1 1/2	57	76.5	48	60	78	48	-	-	-	-	
	50A	2	70	92	57	73	94	57	-	-	-	-	

## Cap

RoHS



Type	M Material	S Surface Treatment
SGPPC	FCMB270	Hot Zinc Plating
SUTPC	CF-8 Stainless Steel Cast	-

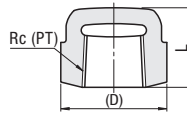

Part Number	Type	No.	Rc (PT)	SGPPC		SUTPC		SGPPC		SUTPC	
				(D)	L	(D)	L	Unit Price	Volume Discount Rate	Unit Price	Volume Discount Rate
SGPPC SUTPC	6A	1/8	19	14	18	16	-	-	-	-	
	8A	1/4	23	15	22	18	-	-	-	-	
	10A	3/8	26	17	26	20	-	-	-	-	
	15A	1/2	31	20	30	21	-	-	-	-	
	20A	3/4	37	24	36	24	-	-	-	-	
	25A	1	45	28	44	28	-	-	-	-	
	32A	1 1/4	54	30	53	30	-	-	-	-	
	40A	1 1/2	61	32	60	32	-	-	-	-	
	50A	2	74	36	73	36	-	-	-	-	

## Plug

RoHS



Type	M Material	S Surface Treatment
SGPPP	FCMB270	Hot Zinc Plating
SUPPP	CF-8 Stainless Steel Cast	-

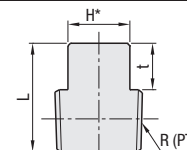

Part Number	Type	No.	R (PT)	Square Size H	t	L		SGPPP		SUPPP	
						SGPPP	SUPPP	Unit Price	Volume Discount Rate	Unit Price	Volume Discount Rate
SGPPP SUPPP	6A	1/8	7	7	16	16	-	-	-	-	
	8A	1/4	9	8	19	19	-	-	-	-	
	10A	3/8	12	9	21	21	-	-	-	-	
	15A	1/2	14	10	26	25	-	-	-	-	
	20A	3/4	17	11	29	28	-	-	-	-	
	25A	1	19	12	31	31	-	-	-	-	
	32A	1 1/4	23	13	35	35	-	-	-	-	
	40A	1 1/2	26	14	36	36	-	-	-	-	
	50A	2	32	15	41	41	-	-	-	-	

\*Shape of H Part: No.6A~50A=Square

## Round Nipple

RoHS

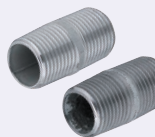

Type	M Material	S Surface Treatment
SGPNP	SGP	Hot Zinc Plating